



DESCRIPTION

- One stage
- 240 volts
- 5.3"/135 mm diameter
- Double ball bearings
- One speed
- Thru-Flow discharge
- Thermostat fan end bracket
- Aluminum top bracket

DESIGN APPLICATION

- Equipment operating in environments not requiring separation of working air from motor ventilating air
- Designed to handle clean, dry, filtered air only
- Typical application--commercial backpack

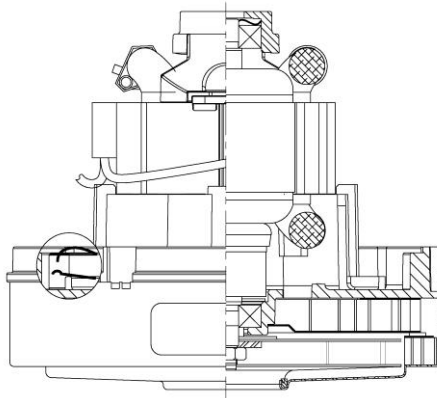

SPECIAL FEATURES

- Suitable for 240 volt AC operation, 50/60 Hz
- UL recognized, category PRGY2 (E56617)
- Skeleton frame design
- Tapered fan system
- Curve brush design
- Integrated Diffusion System
- Lead terminals
- The AMETEK/Lamb product line offer a wide range of performance levels to meet design needs.

TYPICAL PERFORMANCE.*

(At 240 volts, 50Hz, test data is corrected to standard conditions of 29.92 Hg, 68° F.)

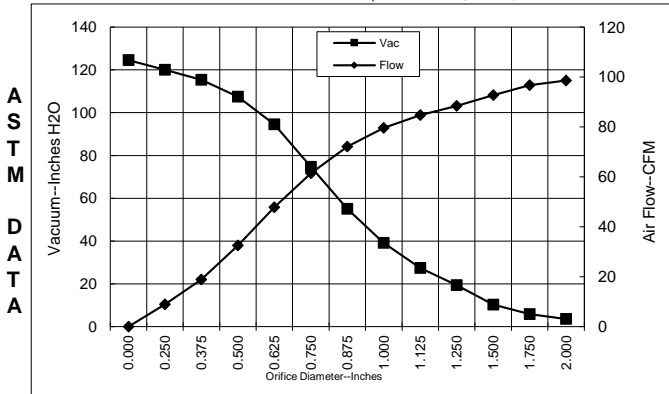

Orifice (Inches)	Amps	Watts (In)	RPM	Vac (In.H ₂ O)	Flow (CFM)	Air Watts
2.000	6.8	1554	31320	3.6	98.6	41
1.750	6.8	1552	31370	5.9	96.7	67
1.500	6.7	1544	31470	10.3	92.7	112
1.250	6.7	1524	31715	19.4	88.4	202
1.125	6.5	1499	31865	27.3	84.7	272
1.000	6.4	1469	32215	39.2	79.6	366
0.875	6.2	1422	32760	55.1	72.1	466
0.750	5.9	1346	33555	74.7	61.4	539
0.625	5.4	1241	34745	94.5	47.8	530
0.500	4.8	1120	36235	107.5	32.5	410
0.375	4.4	1021	37725	115.4	18.9	256
0.250	4.0	934	39165	120.0	8.9	125
0.000	3.6	855	40750	124.5	0.0	0

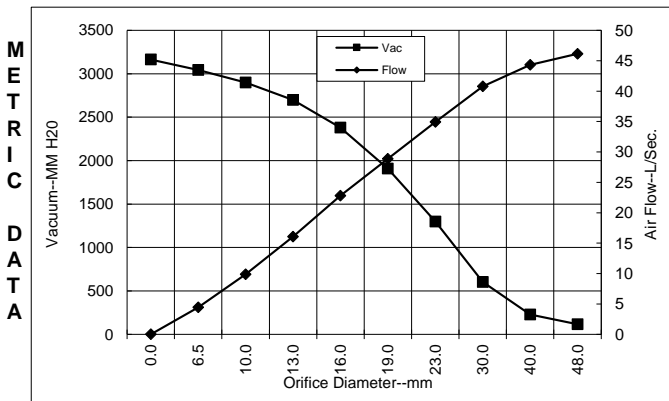

Orifice (mm)	Amps	Watts (In)	RPM	Vac (mm H ₂ O)	Flow (L/Sec)	Air Watts
48.0	6.8	1553	31342	116	46.1	52
40.0	6.7	1546	31440	228	44.3	99
30.0	6.6	1510	31798	604	40.8	241
23.0	6.2	1434	32624	1298	34.9	441
19.0	5.8	1344	33579	1908	28.9	539
16.0	5.4	1245	34697	2380	22.8	530
13.0	4.9	1132	36086	2697	16.1	422
10.0	4.5	1036	37502	2900	9.9	279
6.5	4.0	938	39093	3043	4.4	132
0.0	3.6	855	40750	3163	0.0	0

Note: Metric performance data is calculated from the ASTM data above.

* Data represents performance of a typical blower sampled from a large production quantity. Individual unit data may vary to normal manufacturing variations.

Test Specs:	240 Volts	Minimum Sealed Vacuum:	107.0	ORIFICE:	7/8	Minimum Vacuum:	46.0	Maximum Watts:	1462
-------------	-----------	------------------------	-------	----------	-----	-----------------	------	----------------	------

DIMENSIONS

NOTES:

1. MODEL NUMBER, DATE OF MANUFACTURE, PLANT LOCATION CODE, AGENCY RECOGNITION CODE, INSPECTOR'S CODE, MANUFACTURER'S NAME, "US PATENT: US 6,703,754 B1 & PATENTS PENDING", VOLTAGE AND FREQUENCY, AND CUSTOMER'S PART NO. TO APPEAR ON MOTOR.
2. LEADS: 18GA STRANDED.
3. RECOMMENDED SCREW SIZE 10-16 TYPE BT OR 25 THREAD CUTTING SCREW.

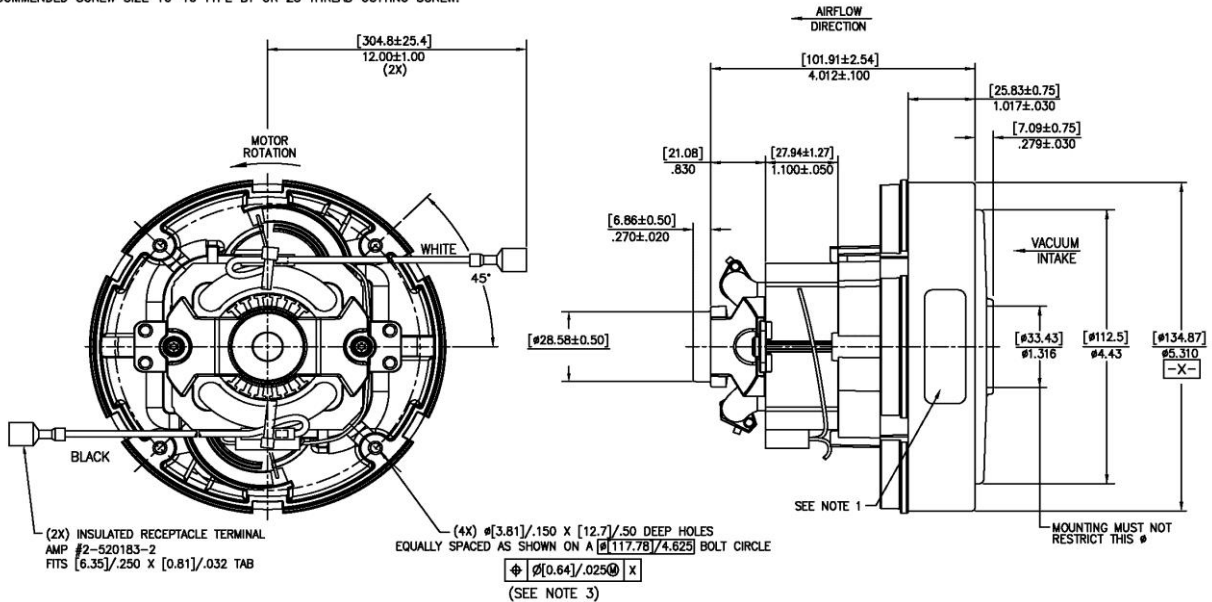

IMPORTANT NOTE: Pictorial and dimensional data are subject to change without notice. Contact factory for current revision levels.

WARNING - Ametek/Lamb Electric thru-flow vacuum blowers must never be used in applications in which wet or moist conditions are involved, where dry chemicals or other volatile materials are present or where airflow may be restricted or blocked. Such motors are designed to permit the vacuumed air to pass over the electrical winding to cool it. Thus any foam, liquid (including water), dry chemical or other foreign substance will come in contact with electrical conductors which could cause combustion (depending on volatility) or electrical shock. Failure to observe these precautions could result in property damage and severe personal injury, including death in extreme cases. All applications incorporating Lamb blowers should be submitted to Underwriters Laboratories Inc. or other appropriate organizations or agencies for testing specifically related to the safety of your equipment.

AMETEK/Floorcare & Specialty Motors
www.ametekfsm.com

Revised: Sep, 2016