

LAMB ELECTRIC

Model: 119559-00

DESCRIPTION

- Two stages
- 220 volts
- 5.7"/145 mm diameter
- Double ball bearings
- Single speed
- Thru-flow discharge
- Aluminum fan end bracket
- Aluminum commutator bracket

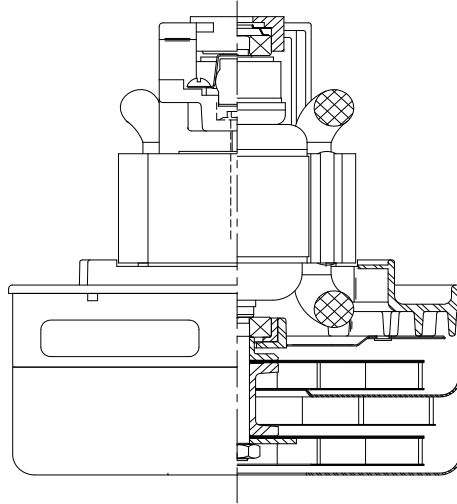

SPECIAL FEATURES

- Suitable for 220 volt AC operation, 50/60 Hz
- UL recognized, category PRGY2 (E47185)
- No shaft extension
- Provision for grounding
- Skeleton-frame design
- The Lamb Electric vacuum motor line offers a wide range of performance levels to meet design needs

DESIGN APPLICATION

- Equipment operating in environments not requiring separation of working air from motor ventilating air
- Designed to handle clean, dry, filtered air only

TYPICAL MOTOR PERFORMANCE.*

(At 220 volts, 50Hz, test data is corrected to standard conditions of 29.92 Hg, 68° F.)

ASTM DATA

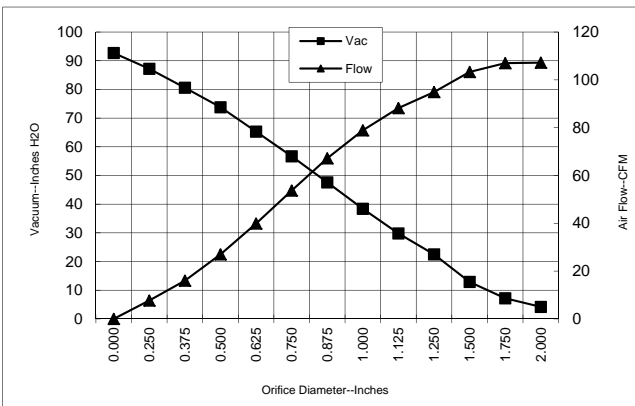

Orifice (Inches)	Amps	Watts (In)	RPM	Vac (In.H ₂ O)	Flow (CFM)	Air Watts
2.000	5.2	1092	19750	4.2	107.2	53
1.750	5.2	1094	19650	7.2	107.0	91
1.500	5.2	1090	19750	12.9	103.3	156
1.250	5.1	1086	19750	22.5	94.9	251
1.125	5.1	1084	19750	29.8	88.2	308
1.000	5.1	1077	19850	38.4	78.9	356
0.875	5.0	1049	20050	47.6	67.2	376
0.750	5.0	1008	20550	56.7	53.7	357
0.625	4.5	949	21250	65.3	39.9	306
0.500	4.1	881	22140	73.8	27.0	234
0.375	3.8	819	23140	80.6	16.0	151
0.250	3.5	764	24140	87.2	7.7	79
0.000	3.2	699	25040	92.7	0.0	0

METRIC DATA

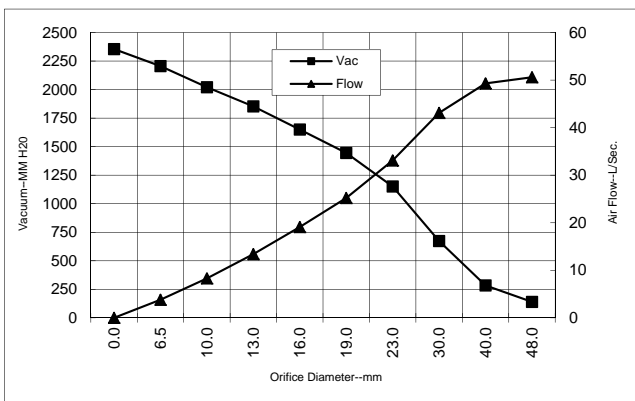

Orifice (mm)	Amps	Watts (In)	RPM	Vac (mm H ₂ O)	Flow (L/Sec)	Air Watts
48.0	5.2	1093	19706	140	50.6	70
40.0	5.2	1091	19720	284	49.3	137
30.0	5.1	1085	19750	673	43.1	282
23.0	5.0	1056	20000	1151	33.1	371
19.0	4.9	1007	20564	1445	25.2	356
16.0	4.5	951	21222	1650	19.1	308
13.0	4.2	888	22051	1853	13.4	241
10.0	3.9	828	22990	2021	8.3	163
6.5	3.6	767	24090	2206	3.8	83
0.0	3.2	699	25040	2355	0.0	0

Note: Metric performance data is calculated from the ASTM data above.

* Data represents performance of a typical motor sampled from a large production quantity. Individual motor data may vary due to normal manufacturing variations.

Test Specs:	220 volts	Minimum Sealed Vacuum:	88.0"	ORIFICE:	7/8 "	Minimum Vacuum:	44.0"	Maximum Watts:	1053
--------------------	-----------	-------------------------------	-------	-----------------	-------	------------------------	-------	-----------------------	------

